



Vespa GTS250IE/GTV250IE

Thank you for selecting and purchasing a TiForce exhaust system for your Vespa GTS250IE/GTV250IE. TiForce is the world's finest titanium exhaust system available today. Please read the following instructions and materials to fully familiarize you with new exhaust system before getting started.

We recommend the installation be done by your nearest dealer or specialist.

Before Installation

- Verify that all parts and accessories have been included (see list below).
 - Coat all exhaust pipe matching joints with anti-seize compound / lubricant.
 - Read and review the instructions, cautions, diagrams and images prior to starting any work.
 - For your safety, detach the batteries.
 - Use new exhaust gasket.
 - TiForce recommends the use of light-duty thread locking agent (ie Blue Loctite) on all exhaust mounting fasteners - especially the fasteners on passenger footrest brackets and all silencer mounting hardware.
1. Remove the stock Silencer.
 2. Put enclosed clamp band to the TiForce tail pipe. Lightly attached the assembled tail pipe to the head pipe.
 3. Insert the enclosed TiForce can to the lightly attached tailpipe section. Put the silencer band and rubber to the can. Jiggle the whole assemble for better fitment. Lightly attach the assembled silencer section (see Fig. 1) by enclosed aluminum collar, cap bolt (M8x75mm) and M8 large washer.
 4. Make sure the exhaust pipe and silencer are free and clear, if necessary jiggle the system to adjust for proper clearance.
 5. Securely fasten the tailpipe section followed by the assembled silencer.
 6. Attach enclosed spring to the silencer joint.
 7. Using some brake and contact cleaner on a clean rag, carefully wipe down the entire exhaust system to remove any residual oils, anti seize, fingerprints and dirt prior to starting the motor. **FAILURE TO CLEAN THE TUBING AND CAN MAY RESULT IN PERMANENT STAINING OF THE SYSTEM WHEN HEATED.**
 8. Make sure all bolts and nuts are securely fastened. Start the motor and check for exhaust leaks.
- End



General Cautions for Exhaust System Installations

CAUTION –For your safety, carefully read these instructions and those above, and fully familiarize yourself with the content before beginning installation and use. Keep these instructions in a safe place for future reference. Install the exhaust system as explained in these instructions.

DANGER –when the motor is running, and shortly after it has been turned off, the motorcycle, the exhaust system and end-can will be hot. Severe burns, bodily injury and even death may result.

DANGER –Keep gasoline and other flammable materials away from the exhaust system at all times. Exposure of gasoline and to heat can lead to fire.

CAUTION –Stop the motorcycle should the exhaust system come in contact with people or animals. Never touch the exhaust system when hot. Direct contact with the system can cause burns.

DANGER –Allow the motor to cool before installing or removing the exhaust system. Working with a hot motor can lead to burns.

CAUTION –Stand the motorcycle on a flat and level surface and ensure that the motorcycle is stable before installing the exhaust system. Bodily injury and /or death could result to you or others if the motorcycle falls over. Damage may also result to the motorcycle or nearby property or equipment.

DANGER –Start and run the motorcycle in a well-ventilated area. With prolonged exposure to exhaust gas you run the risk of severe oxygen deficiencies, bodily injury or death may result.

CAUTION –Install the muffler only on the specified model of motorcycle. Improper installation will lead to loss of performance and or damage to the motorcycle.

CAUTION –Do not disassemble, modify or remodel this exhaust system

TiForce Japan Co., Ltd	81-593-701881 tel	http://www.tiforce.com
8160-1,Kou-cho	81-593-701882 fax	sales@tiforce.com
Suzuka city, Mie		
513-0836, Japan		

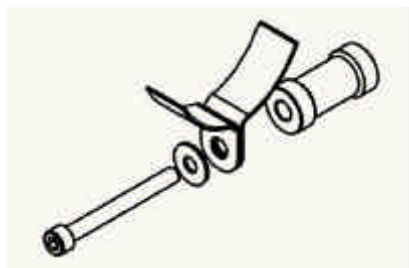

Fig. 1 attachment of the silencer band



Enclosed parts

Tail pipe : 1pc

Silencer Band : 1 pc

Short spring : 1pc

Aluminum collar (25x8.5x53mm)

TiForce can : 1pc

Band rubber : 1pc

8x75mm bolt : 1 pc

: 1 pc

Cramp band : 1pc

M8 large washer:1 pc

