



## 2 Remove STD foot peg from the motor bike body.

Remove the brake master ASSY and brake switch from the brake-side STD step.

For the shift-side, engine-side change arm only requires the STD, therefore remove the link arm from the STD link.

## 3 Attach the right-side step plate to the motor bike body.

(1) Remove the hexagon flanged bolts (No.25) and button screw (No. 33) which is holding the master cylinder stay. After applying the screw lock paste to the bolt, attach it to the place of your choice with the hexagon flanged bolt (No.25) and bottom bolt (No.33).

(2) Change the STD parts for the foot peg to the one you use.

- Master cylinder
- Stop switch
- Button cap bolt x2

? Step position: For 0back/20up, change the direction of the hose so that the master cylinder upper parts banjo does not touch with the frame. (Pic 1)

(3) For the brake-side only, insert the collar (No.16) between the frame and R-side step plate (No.2), and tighten with the cap-bolt (No. 26)

(4) Adjust the brake light switch. (Check the brake light comes on when you press the pedal.)

Note: If you are unable to adjust with the switch screw, change the angle of the switch stay and/or the brake arm side spring stay.

If you make adjustment to the switch stay, check that no parts interfere with other parts.

(5) Check no part touches the other parts.

- Check all bolts and nuts are securely tightened.
- It is essential you check the hose bent between the R master and fluid reservoir, as well as the brake hose mechanism, when the swing arm goes up and down.

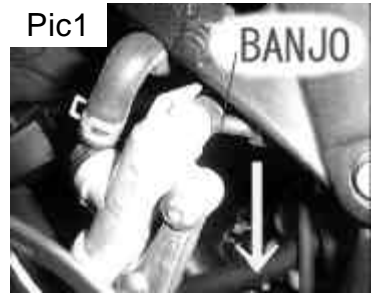

## 4 Attach the left-side foot peg plate to the motor bike body

(1) Attach the peg to the body.

(2) Adjust the length of the change rod and position of the pedal.

Make sure the screws have more than 6mm engagement at the all three change rods.

(3) Check no parts interfere with others.

Check all bolts and nuts are securely tightened.

## 5 Adjustment of change rod

Tighten the change rod and adjust the change pedal height. If the spherical bearing is too short or long, and you cannot make to your required heights, change the angle of the change arm and adjust the length of the change rod.

- In case of reverse position, change the direction of change arm. ( Pic. 2)

## 6 Confirmation

(1) Check before run

- No parts interfere other parts. (Especially moving parts.)
- All moving parts work smoothly.
- All bolts and nuts are securely tightened.
- If the rear brake works.
- If the brake light operates.

(2) Check after the run

- If the shift to each gear can be done smoothly.
- If all bolts and nuts are still securely tightened.

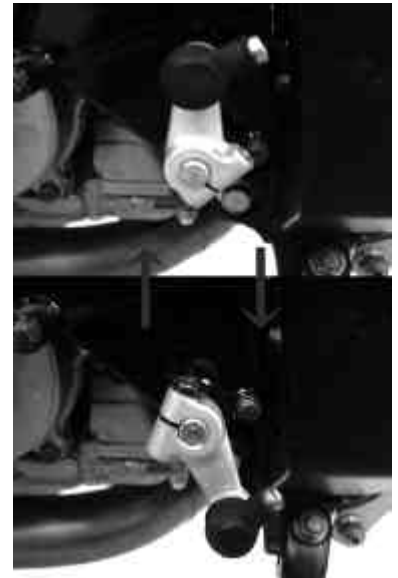

Pic 2

## 【About maintenance】

Please keep the bearing and spherical bearing parts oiled at all times to ensure smooth operation.

The bolts and nuts can be loosened by vibration. Please regularly tighten them.

Especially after a fall, check the bolts and nuts.

【Parts list】

Utmost care is provided to the quality for the product. In case of ambiguity, stop using it immediately and contact us. Please contact below for inquiry on installation and maintenance, or claims.

No.	item name	qty.
1	LEFT SIDE STEP PLATE	1
2	RIGHT SIDE STEP PLATE	1
3	LEFT SIDE HEEL GUARD	1
4	RIGHT SIDE HEEL GUARD	1
5	LEFT SIDE STEP BAR	1
6	RIGHT SIDE STEP BAR	1
7	CHANGE PEDAL	1
8	BRAKE PEDAL	1
9	MASTER CYLINDER STAY	1
10	CHANGE ROD M6XL40	1
11	STUD BOLT M6XL110	1
12	STAY 1, BRAKE LIGHT SWITCH	1
13	STAY 2, BRAKE LIGHT SWITCH	1
14	BEARING COLLAR	1
15	COLLAR f 6.2Xf 12XL6	1
16	COLLAR f 8.2Xf 22XL5	2
17	COLLAR f 6.2Xf 10XL13	1
18	BRAKE MASTER PIN	1
19	MASTER CYLINDER NUT	1
20	PEDAL BAR	2
21	PEDAL RUBBER	2
22	SPLIT PIN	1
23	SPHERICAL BEARING	1
24	HEXAGON FLANGED BOLT M8XL65	1
25	HEXAGON FLANGED BOLT M6XL50	1
26	CAP BOLT M8XL25	2
27	CAP BOLT M8XL20	2
28	FLUSH BOLT M8XL35	1
29	CAP BOLT M6XL30	1
30	CAP BOLT M6XL20	1
31	CAP BOLT M6XL12	1
32	BUTTON CAP BOLT M6XL20	1
33	BUTTON CAP BOLT M6XL10	4
34	FLUSH BOLT M6XL25	2
35	FLANGE ROCK NUT M8	2
36	THIN ROCK NUT M6	1
37	THICK ROCK NUT M6	1
38	NUT M6	2
39	WASHER FOR M8 (LARGE)	2
40	WASHER FOR M6	1
41	SWITCH SPRING	1

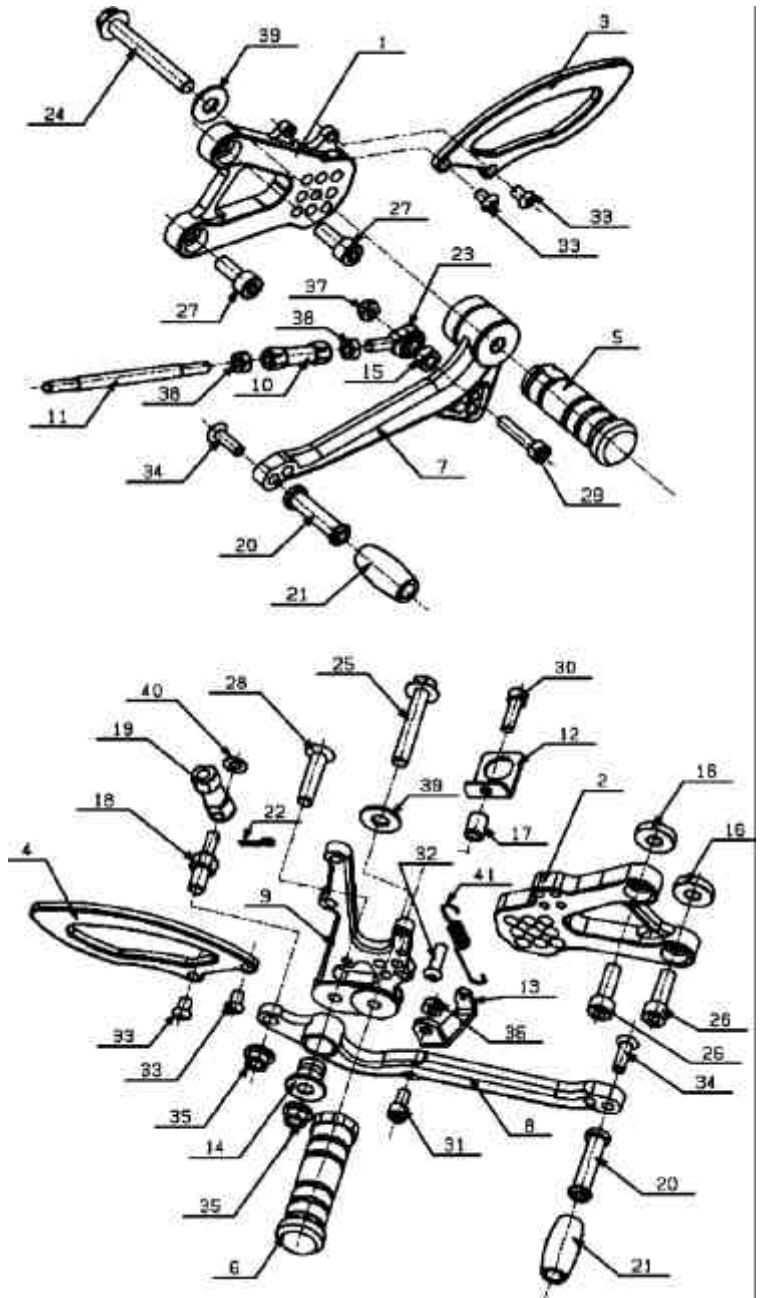

TiForce Japan Co., Ltd.  
 13-25, Minami Ejima  
 Suzuka city, Mie  
 510-0235, Japan

81-593-873992 tel  
 81-593-873993 fax

<http://tiforce.co.jp>  
[sales@tiforce.co.jp](mailto:sales@tiforce.co.jp)