



Adjustable foot peg kit for Suzuki GSX-R1000 Users Manual

Thank you for purchasing Ti-Force original parts. Please read the information below for safe use of our product.

! Caution !

To prevent burns, work must be conducted only after the engine has properly cooled down.

To ensure the bike does not fall over as you work on it, make sure it is stood on level ground.

During the installation of the kit make sure that all parts are securely tightened to prevent from falling plate or loose master-cylinder. Pay special attention to the brake system, errors can cause serious injury.

After installation, make sure that the parts of the kit are not touching other parts.

Some parts are loosely tightened at the time of shipment. Please make sure all parts are securely tightened during the installation.

Vibration can loosen the bolts while riding. Please regularly check all parts are securely tightened.

Especially after any fall accident, please make a thorough check.

This product is for standard motorbikes and those with our exhaust installed. There is possibility that this product cannot be installed when the motorbike has another non-standard exhaust, swing arm or frame, etc.

Do not dismantle or alter our product. (It causes loss of function, and could cause fatal accidents.)

Please note we cannot accept return of a kit when it has been illegally used or installed.

If the motorbike has had a fall and its frame has been damaged, the installation of the kit may not be possible.

In case of accident and damage to our product, please do not use. The broken parts may cause harm to the rider. The accident might cause the exhaust to fall off the motorbike and thus fatal accident or injury.

- 【Spec】
- 《Suitable motor bike》 07-GSXR1000
 - 《Position》 Nine positions available
 - 《Other info》 Shift Stroke of two levels adjustment
 - A-high, B-low
 - Standard fitment or in the reverse position.
 - Passenger foot pegs can be used.

【Required Tools etc.】

- 《Tools》 Hexagon wrench 4mm, 5mm, 6mm, one of each
- Spanner 12mm, 13mm one of each
- Spanner 10mm, two
- Torque wrench, Plier, Spring puller
- 《Others required》 Gloves, Screw stop paste, grease, Cloth

【Tightening Torque】

Recommended Tightening Torque

Screw diameter	N-m	Kg f-m
M6 Bolt, Nut	10	1.0
M8 Bolt, Nut	22	2.2

1 Position confirmation

Confirm the position.

There are three step positions:

? 0 mm Back/ 0mm U P	? 10 mm Back/ 0mm U P	? 0mm Back/10mm U P
----------------------	-----------------------	---------------------

And there are three motorbike body positions:

? 0 mm Back/ 0mm U P	? 0mm Back/ 14mm U P	? 14 mm Back/14mm U P
----------------------	----------------------	-----------------------

Please choose your position from total 9 positions (3 step positions x 3 motorbike body positions.)

2 Remove STD foot peg from the motor bike body.

Remove the brake master ASSY and brake switch from the brake-side STD step.

For the shift-side, engine-side change arm only requires the STD, therefore remove the link arm from the STD link.

3 Attach the right-side step plate to the motor bike body.

- (1) Remove the button bolt (No.23) and (No. 24) which is holding the master cylinder stay. After applying the screw lock paste to the bolt, attach it to the place of your choice with the button bolt (No.23) and t (No. 24).
- (2) Change the following STD parts for the foot peg.
 - Master cylinder
 - Brake light switch
- (3) Adjust the brake light switch. (Check the brake light comes on when you press the pedal.)
Note: If you are unable to adjust with the switch screw, change the angle of the switch stay and/or the brake arm side spring stay.
If you make adjustment to the switch stay, check that no parts interfere with other parts.
- (4) Check no part touches the other parts.
 - Check all bolts and nuts are securely tightened.
 - It is essential you check the hose bent between the R master and fluid reservoir, as well as the brake hose mechanism, when the swing arm goes up and down.

4 Attach the left-side foot peg plate to the motor bike body

- (1) Attach the peg to the body.
- (2) Adjust the length of the change rod and position of the pedal.
Make sure the screws have more than 6mm engagement at the all three change rods.
- (3) Check no parts interfere with others.
Check all bolts and nuts are securely tightened.

5 Adjustment of change rod

Tighten the change rod and adjust the change pedal height. If the spherical bearing is too short or long, and you cannot make to your required heights, change the angle of the change arm and adjust the length of the change rod. (See Pic.1)

6 Confirmation

- (1) Check before run
 - No parts interfere other parts. (Especially moving parts.)
 - All moving parts work smoothly.
 - All bolts and nuts are securely tightened.
 - If the rear brake works.
 - If the brake light operates.
- (2) Check after the run
 - If the shift to each gear can be done smoothly.
 - If all bolts and nuts are still securely tightened.

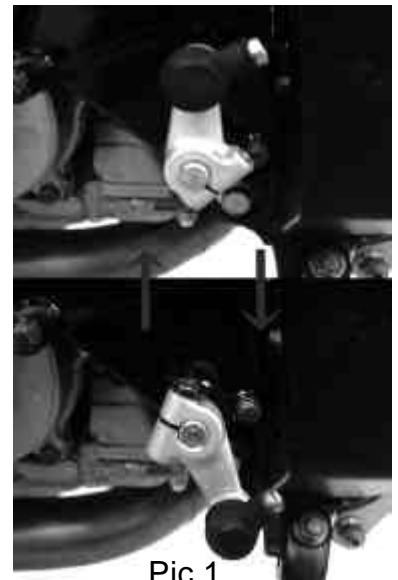

【About maintenance】

Please keep the bearing and spherical bearing parts oiled at all times to ensure smooth operation. The bolts and nuts can be loosened by vibration. Please regularly tighten them. Especially after a fall, check the bolts and nuts.

【Parts list】

Utmost care is provided to the quality for the product. In case of ambiguity, stop using it immediately and contact us. Please contact below for inquiry on installation and maintenance, or claims.

No	ITEM NAME	QTY.
1	STEP PLATE, L	1
2	STEP PLATE R	1
3	MASTER CYLINDER STAY	1
4	HEAL GUARD, L	1
5	HEAL GUARD, R	1
6	STEP BAR (SHORT)	2
7	CHANGE PEDAL	1
8	BRAKE PEDAL	1
9	PEDAL BAR	2
10	PEDAL INNER COLLAR	1
11	PEDAL RUBBER	2
12	FLASH CAP BOLT M6XL25	2
13	PUSH ROD PIN	1
14	SWITCH STAY	1
15	SWITCH SPRING STAY	1
16	SPHERICAL BEARING(UAFL)	1
17	COLLAR 10*6.2*9	1
18	COLLAR 12*6.2*3	2
19	CAP BOLT M8x L20	4
20	CAP BOLT M8x L60	1
21	CAP BOLT M8x L70	1
22	BUTTON BOLT M6x L10	4
23	BUTTON BOLT M6x L15	2
24	BUTTON BOLT M6x L25	4
25	U NUT M6R	3
26	U NUT M8	1
27	LOW U NUT M6	1
28	LOW U NUT M6 L	1
29	WASHER M8	2
30	SPLIT PIN 2*20	1

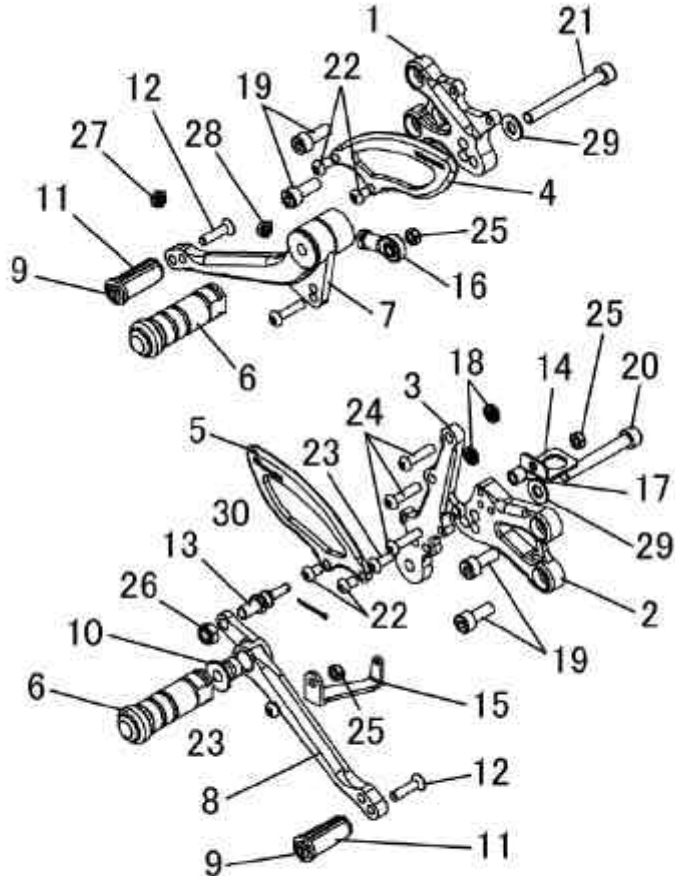

TiForce Japan Co., Ltd.
 6130-1, Kou-cho
 Suzuka city, Mie
 513-0836, Japan

81-593-701881 tel <http://tiforce.com>
 81-593-701882 fax sales@tiforce.co.jp