



## Kawasaki '07- ZX6R Full System

Thank you for selecting and purchasing a TiForce exhaust system for your ZX6R. TiForce is the world's finest titanium exhaust system available today. Please read the following instructions and materials to fully familiarize yourself with your new exhaust system before getting started. Instructions are also available in Adobe Acrobat PDF format on the TiForce website ([www.tiforce.co.jp](http://www.tiforce.co.jp)).

### Before Installation

- Verify that all parts and accessories have been included (see list below).
  - Coat all exhaust pipe matching joints with anti-seize compound / lubricant.
  - Read and review these instructions, cautions, diagrams and images prior to starting any work.
  - TiForce recommends the use of light-duty thread locking agent (ie Blue Loctite) on all exhaust mounting fasteners – especially the fasteners on passenger footrest brackets and all silencers mounting hardware.
1. Remove the faring lowers(save STD bolts for reuse), side faring (save STD bolts for reuse), seat faring (save front 2 STD bolts for reuse) and right silencer cover.
  2. Detach the turn signal assy, (unplug the cable coupler of turn signal and brake light at the same time)
  3. Remove the radiator under bracket and lightly unscrew the radiator mounting bolt. Move the radiator forward. This will make you to have enough room for detaching exhaust pipes and flange nuts. Then, take off the standard headpipes. Detach the cable of the exhaust device and leave servomotor stayed in the motorbody. (save (3) STD bolt and nut and (8) flange nuts for reuse)
  4. Assemble the enclosed head pipes 1,2,3 and 4 by matching the 4-2-1 joint. Do not install the exhaust springs at this time. Lightly attach the assembled head pipe sections to the exhaust ports. Make sure the ends of the head pipes fit snug in the ports.
  5. Install the tail joint and tail pipe to the joints. Do not install the exhaust springs yet. Jiggle the whole assemble for better fitting. Lightly attach the tail pipe by standard bolt and nut saved in step 3, but do not tighten the bolt fully. (see Image 1)
    - \*Recommend to use new gasket to prevent from leaking the exhaust.
    - \*Lightly screw the (8) STD flange nuts saved in step 3.
    - \* Cylinder number is 1, 2, 3 and 4 from the left hand side with you on the motorbike.



Image 1

6. Attach enclosed silencer stay A to the place where the standard silencer mounted by (2) STD bolts and nuts saved in step 3. Reinstall the seat faring and penetrate the (2) 5x45mm to the hole of a seat faring mounted. Fix the Silencer stay A by enclosed (2) M5 nuts and (2) aluminum collar using the thread of penetrated M5x45bolts. (see Image 2 and drawing 1)



Image 2

7. Insert the TiForce silencer to the tail pipe. Put silencer band and band rubber to the assembled silencer stay A by enclosed (2) M8x20mm bolt and (2) M8 washer. (see drawing 1)
8. Attach the supplied springs to all the joints. Use a spring puller to prevent damage to the springs that could lead to future failure. Put the radiator back to the original position.
9. Attach the L and R license number stay to the silencer stay A. (see Image 3) (see drawing 1)
10. Reinstall the firings detached in step 1. Attach the right silencer cover to the frame by using enclosed faring stay and (1) M6x20mm. (see drawing 1)
11. Make sure the exhaust system is free and clear of the faring. If necessary, adjust for proper clearance.. Removed the fairings reinstalled in step 10.
12. Securely tighten all fasteners in this order (from exhaust pipe flange to silencer stay)



Image 3

14. Attach the turn signal assy detached in step 2 to the license number stay. (Use (4) M6x15mm) (See Image 4) Plug the cable couplers.



Image 4

13. Using some brake and contact cleaner on a clean rag, carefully wipe down the entire exhaust system to remove any residual oils, anti seize, fingerprints and dirt prior to starting the motor. **FAILURE TO CLEAN THE TUBING AND CAN MAY RESULT IN PERMANENT STAINING OF THE SYSTEM WHEN HEATED.**
14. Check that all fasteners are tightened per specifications, then start the motor and check for exhaust leaks. Make sure the turn signal and brake light turn on.
15. Reinstall the fairings.

End

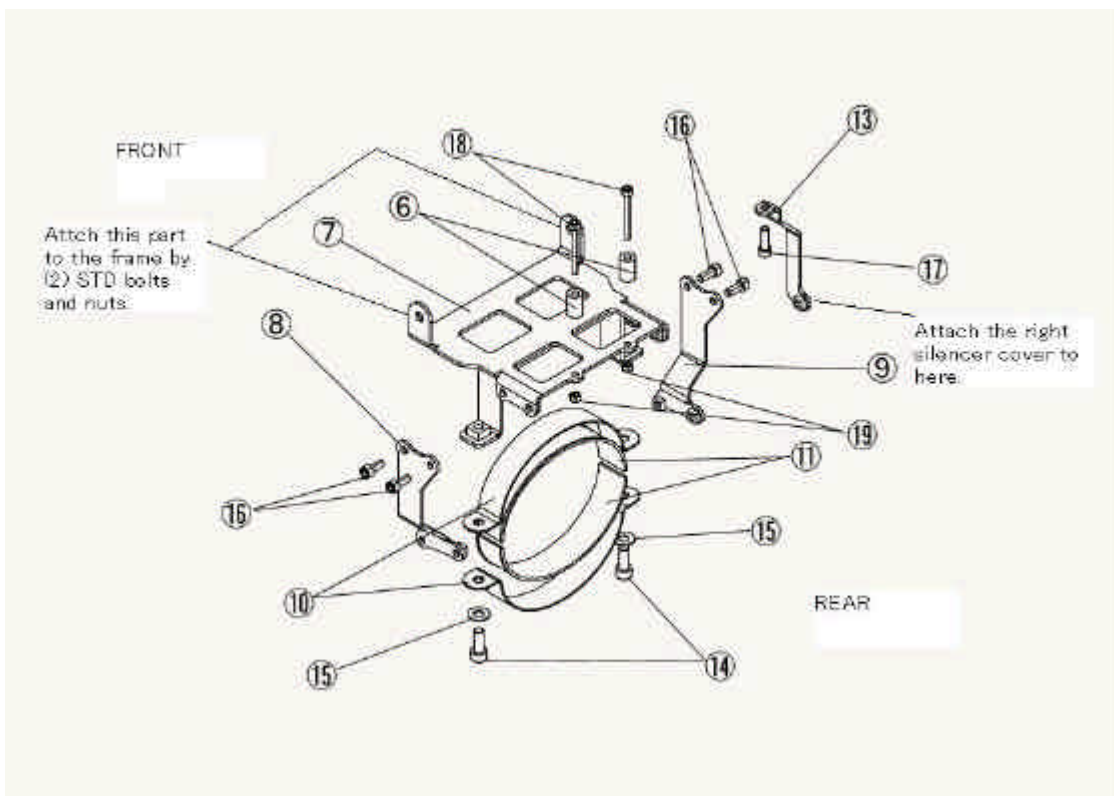

Drawing 1



### General Cautions for Exhaust System Installations

**CAUTION** –For your safety, carefully read these instructions and those above, and fully familiarize yourself with the content before beginning installation and use. Keep these instructions in a safe place for future reference. Install the exhaust system as explained in these instructions.

**DANGER** –when the motor is running, and shortly after it has been turned off, the motorcycle, the exhaust system and end-can will be hot. Severe burns, bodily injury and even death may result.

**DANGER** –Keep gasoline and other flammable materials away from the exhaust system at all times. Exposure of gasoline and to heat can lead to fire.

**CAUTION** –Stop the motorcycle should the exhaust system come in contact with people or animals. Never touch the exhaust system when hot. Direct contact with the system can cause burns.

**DANGER** –Allow the motor to cool before installing or removing the exhaust system. Working with a hot motor can lead to burns.

**CAUTION** –Stand the motorcycle on a flat and level surface and ensure that the motorcycle is stable before installing the exhaust system. Bodily injury and /or death could result to you or others if the motorcycle falls over. Damage may also result to the motorcycle or nearby property or equipment.

**DANGER** –Start and run the motorcycle in a well-ventilated area. With prolonged exposure to exhaust gas you run the risk of severe oxygen deficiencies, bodily injury or death may result.

**CAUTION** –Install the muffler only on the specified model of motorcycle. Improper installation will lead to loss of performance and or damage to the motorcycle.

**CAUTION** –Do not disassemble, modify or remodel this exhaust system.

---

TiForce Japan Co., Ltd      81-593-701881 tel      <http://www.tiforce.co.jp>  
8160-1,Kou-cho              81-593-701882 fax      [sales@tiforce.co.jp](mailto:sales@tiforce.co.jp)  
Suzuka city,Mie  
513-0836, Japan

#### Enclosed Parts List

1	Head pipes #1-#4	1ea	2	4-2-1 joint	1pc	3	Middle pipe	1pc
4	Tail pipe	1pc	5	Silencer	1pc	6	Aluminum collar	2pcs
7	Silencer stay A	1pc	8	License number stay L	1pc	9	License number stay R	1pc
10	Silencer band	2pcs.	11	Band Rubber	2pcs	12	Joint short springs	10 pcs.
13	Faring stay	1pc	14	M8x20mm cap bolt	2 pcs.	15	M8 washer	2 pcs.
16	M6x15mm cap bolt	4pcs.	17	M6x20mm cap bolt	1pc	18	M5x45mm cap bolt	2 pcs.
19	M5 flange nut	2 pcs.						