



## KAWASAKI '06- ZZR1400/ZX-14, STD

Thank you for selecting and purchasing a TiForce exhaust system.

TiForce is the world's finest titanium exhaust system available today. Please read the following instructions and materials to fully familiarize you with new exhaust system before getting started.

### Before Installation

- Verify that all parts and accessories have been included (see list below).
  - Coat all exhaust pipe mating joints with anti-seize compound / lubricant.
  - Read and review these instructions, cautions, diagrams and images prior to starting any work.
1. Remove the under-cowl first, and then remove the side-cowl next.
  2. Remove the under radiator mounting bolt and lightly unscrew the upper mounting bolt. Then move radiator to forward. This will make you to have enough room for detaching exhaust pipe and flange bolt.
  3. Detach the left and right silencers.
  4. Remove the exhaust pipe flange nut and detach the front pipes. Save this flange nut for reuse.
  5. Remove the bush of the right silencer stand stopper and attach this bush to the supplied stand stopper. Detach the spring of the center stand and remove spring hook mounting bolt of the body side. And attach the reassembled center stand stopper between the body and the spring hook. And attach the spring detached in previous procedure to the center stand stopper. (For North America Spec. motorbike, please skip this No.5)
  6. Lightly attach the front pipe from #1 to #4 to the engine. Next lightly attach the 2-1 joints to the head pipes and then lightly attach the tail pipe to the joint. Lastly, lightly attach the tail pipe stay to the motorcycle body by enclosed M8 x 50 cap bolt x 1, M8 washer x 1 and M8 flange lock nut x 1). (cylinder number is 1,2,3 and 4 from the engine right side)
    - \*Use new gasket to prevent the exhaust leaks
    - \* Use a standard flange nut and lightly tighten by hand
  7. Lightly attach the enclosed silencer stay to the right standard silencer mounting position by M8 x 75 cap bolt x 1, M8 flange lock nut x 1, M8 washer x 1 and aluminum collar. (see drawing 1)
  8. Insert the tail pipe to the silencer and attach this to the enclosed silencer stay by enclosed silencer band, band rubber, M6 cap bolt, and washer and M6 rock nut.
  9. Attach supplied springs to each joint.
  10. Shake the whole assemble to have a better fitting. And lightly screw the flange nut, next tail pipe stay and then silencer.
  11. Lightly attach the cowls removed in step 1 and make sure the exhaust system is free and clear; if necessary jiggle the system to adjust for proper clearance.



12. Remove the cowl reattached in step 11. Securely tighten the exhaust flange and then silencer stay. And return the radiator to the previous position. Using some brake and contact cleaner on a cleaning; carefully wipe down the entire exhaust system to remove any residual oils, anti-seize, fingerprints and dirt prior to starting the motor. (Failure to clean the tubing and silencer may result in permanent starting of the system when heated.)
13. Check that all hardware is tightened, then start the motor and check for exhaust leaks.
14. Reinstall the faring and tighten any fasteners per factory specification.

END

#### Enclosed parts

1. Exhaust pipe # 1 to 4: each one					
2. 2-1 joint (#1-#2)	1	8. M6 washer	4	14. Silencer stay	1
3. 2-1 joint (#3-#4)	1	9. M6 lock nut	2	15. Aluminium ollar(22x8.5x22mm)	1
4. Tail pipe	1	10. M8 x 50 cap bolt	1	16. Silencer band	2
5. Silencer	1	11. M8 x 75 cap bolt	1	17. Band rubber	2
6. Joint short springs	8	12. M8 flange lock nut	2	*18 Centre stand stopper	1
7. M6 x 20 cap bolt	2	13. M8 washer	2		

\*18 center stand stopper : no need for North America spec. motorbike

## General Cautions for Exhaust System Installations

**CAUTION** –For your safety, carefully read these instructions and those above, and fully familiarize yourself with the content before beginning installation and use. Keep these instructions in a safe place for future reference. Install the exhaust system as explained in these instructions.

**DANGER** –when the motor is running, and shortly after it has been turned off, the motorcycle, the exhaust system and end-can will be hot. Severe burns, bodily injury and even death may result.

**DANGER** –Keep gasoline and other flammable materials away from the exhaust system at all times. Exposure of gasoline and to heat can lead to fire.

**CAUTION** –Stop the motorcycle should the exhaust system come in contact with people or animals. Never touch the exhaust system when hot. Direct contact with the system can cause burns.

**DANGER** –Allow the motor to cool before installing or removing the exhaust system. Working with a hot motor can lead to burns.

**CAUTION** –Stand the motorcycle on a flat and level surface and ensure that the motorcycle is stable before installing the exhaust system. Bodily injury and /or death could result to you or others if the motorcycle falls over. Damage may also result to the motorcycle or nearby property or equipment.

**DANGER** –Start and run the motorcycle in a well-ventilated area. With prolonged exposure to exhaust gas you run the risk of severe oxygen deficiencies, bodily injury or death may result.

**CAUTION** –Install the muffler only on the specified model of motorcycle. Improper installation will lead to loss of performance and or damage to the motorcycle.

**CAUTION** –Do not disassemble, modify or remodel this exhaust system.

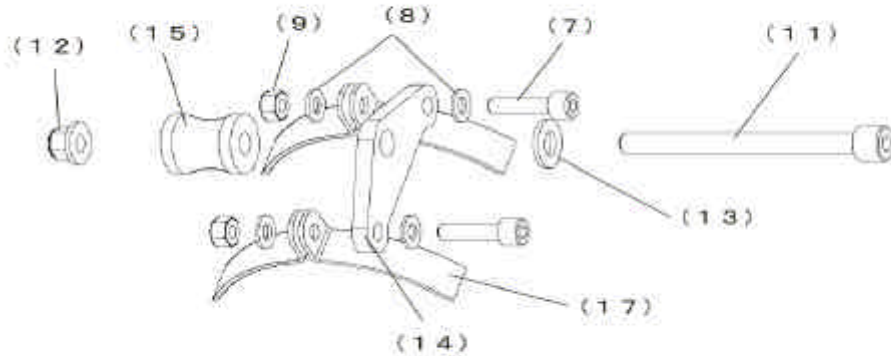

Drawing 1: How to attach the silencer stay

