



KAWASAKI '06-ZZR1400/ZX-14 Slip-on (STD MOUNT)

Thank you for selecting and purchasing a TiForce exhaust system for your ZX-14.

TiForce is the world's finest titanium exhaust system available today. Please read the following instructions and materials to fully familiarize you with new exhaust system before getting started.

Before Installation

- Verify that all parts and accessories have been included (see list below).
 - Coat all exhaust pipe mating joints with anti-seize compound / lubricant.
 - Read and review these instructions, cautions, diagrams and images prior to starting any work.
1. Detach the right and left standard silencer. Remove the clamp band of the exhaust pipe joint and save this for reuse.
 2. Remove the bush of the right silencer stand stopper and attach this to the enclosed stand stopper. (*skip this procedure for the North America spec. motorbike)
 3. Detach the spring of the center stand and unbolt the spring hook plate of the motorbody side. And attach the reassembled center stand stopped in step 2 between the motorbody and the spring hook plate. Attach the spring. (*skip this procedure for the North America spec. motorbike)
 4. Attach the new gasket to the right tail pipe and lightly attach this to the standard exhaust pipe. And lightly attach the tail pipe stay by enclosed M8 x 50 bolt, M8 washer x 1 and M8 lock nut x1.
*recommend using new gasket to prevent gas leak.
 5. Lightly attach the enclosed silencer stay to the right standard silencer mounting position by enclosed M8x55, M8x1 washer, M8x1 lock nut and aluminum collar (24x8.5x13mm) (see. Fig. 2)
 6. Attach the new gasket to the left tail pipe and lightly attach this to the standard exhaust pipe. And lightly attach the enclosed silencer stay to the left standard silencer mounting position by enclosed M8x65, M8x1 washer, M8x1 lock nut and aluminum collar (24x8.5x22mm) (see Fig.1)
 7. Insert the silencer to the right tail pipe and attach the enclosed silencer band x 2 and band rubber x 2 to the silencer. And attach this silencer to the silencer stay by enclosed M6 cap bolt x 2, M6 washer x 4 and M6 lock nut x 2. (see fig. 2)
*Attach the left silencer by the same procedure as the right silencer. (for left silencer hardware attachment, see fig. 1)
 7. Jiggle the whole assembly for proper clearance. And lightly fasten the clamp band saved in step 1 and silence.
 8. Have someone sit on the bike and make sure the whole assemble free and clear. If Necessary, jiggle the whole assembly to adjust for proper clearance. And securely fasten all hardware.
 9. Using some brake and contact cleaner on a cleaning; carefully wipe down the entire exhaust system to remove any residual oils, anti-seize, fingerprints and dirt prior to starting the motor. (Failure to clean the tubing and silencer may result in permanent starting of the system when heated.)
 8. Check that all hardware is tightened, then start the motor and check for exhaust leak. END



Enclosed accessory :(not enclose the center stand stopper for North America market)

1	Left tail pie	1	2	Right tail pipe	1	3	Left silencer	1
4	Right silencer	1	5	Joint short springs	4	6	M6 x 20 cap bolt	4
7	M6 washer	8	8	M6 lock nut	4	9	M8x50mm cap bolt	1
10	M8 x 65mm cap bolt	1	11	M8 x 55mm cap bolt	1	12	M8 flange lock nut	3
13	M8 washer	3	14	Silencer stay	2	15	Aluminium collar(24x8.5x13mm)	1
16	Aluminium collar(24x8.5x22mm)	1	17	Silencer band	4	18	Band rubber	4
19	Center stand stopper	1						

General Cautions for Exhaust System Installations

CAUTION –For your safety, carefully read these instructions and those above, and fully familiarize yourself with the content before beginning installation and use. Keep these instructions in a safe place for future reference. Install the exhaust system as explained in these instructions.

DANGER –when the motor is running, and shortly after it has been turned off, the motorcycle, the exhaust system and end-can will be hot. Severe burns, bodily injury and even death may result.

DANGER –Keep gasoline and other flammable materials away from the exhaust system at all times. Exposure of gasoline and to heat can lead to fire.

CAUTION –Stop the motorcycle should the exhaust system come in contact with people or animals. Never touch the exhaust system when hot. Direct contact with the system can cause burns.

DANGER –Allow the motor to cool before installing or removing the exhaust system. Working with a hot motor can lead to burns.

CAUTION –Stand the motorcycle on a flat and level surface and ensure that the motorcycle is stable before installing the exhaust system. Bodily injury and /or death could result to you or others if the motorcycle falls over. Damage may also result to the motorcycle or nearby property or equipment.

DANGER –Start and run the motorcycle in a well-ventilated area. With prolonged exposure to exhaust gas you run the risk of severe oxygen deficiencies, bodily injury or death may result.

CAUTION –Install the muffler only on the specified model of motorcycle. Improper installation will lead to loss of performance and or damage to the motorcycle.

CAUTION –Do not disassemble, modify or remodel this exhaust system.

TiForce Japan Co., Ltd 81-593-701881 tel <http://www.tiforce.co.jp>
8160-1,Kohanba,Kou-cho 81-593-701882 fax sales@tiforce.co.jp
Suzuka city, Mie 513-0836, Japan

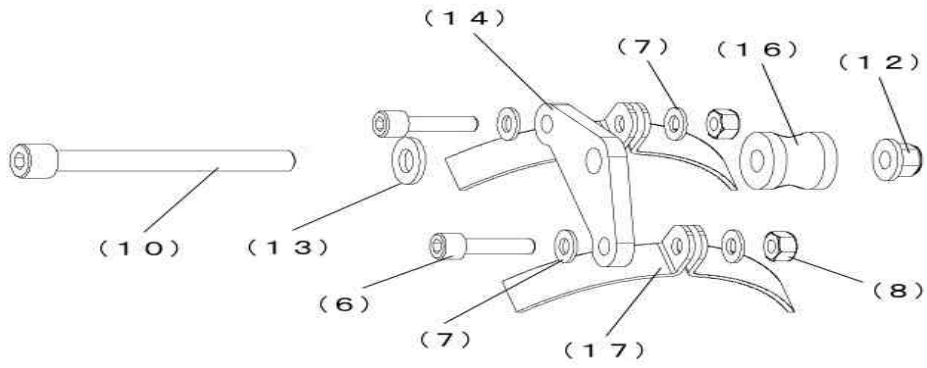

(Fig.1) how to attach the right silencer hardware

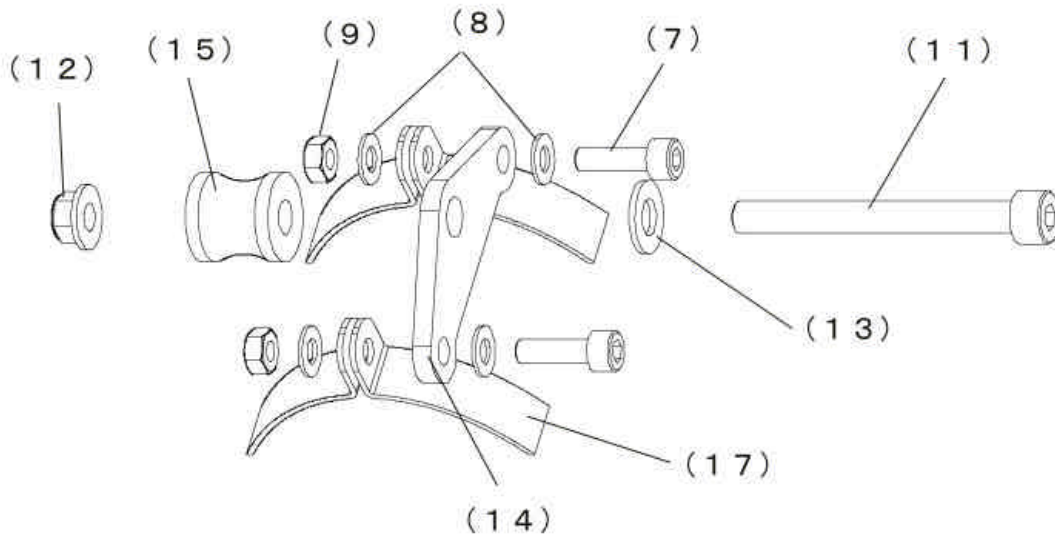

(Fig.2) how to attach the right silencer hardware

