



## 2 Remove STD foot peg from the motor bike body.

Remove the brake master ASSY and brake switch from the brake-side STD step.

For the shift-side, remove all parts including the engine side change arm.

Require to use STD change rod.

## 3 Attach the right-side step plate to the motor bike body.

(1) Remove the flange 6 angle bolt (No.33) and button screw (No.25). After applying the screw lock paste to the bolt, attach it to the place of your choice with the flange angle bolt (No.33) and button screw (No.25) .

(2) Reinstall the STD master cylinder and stop switch to the foot peg. (Pic. 2)

(3) Adjust the brake light switch.

(Check the brake light comes on when you press the pedal.)

Note: If you are unable to adjust with the switch screw, change the angle of the switch stay and/or the brake arm side spring stay.

If you make adjustment to the switch stay, check that no parts interfere with other parts.

(5) Check no part touches the other parts.

- Check all bolts and nuts are securely tightened.
- It is essential you check the hose bent between the R master and fluid reservoir, as well as the brake hose mechanism, when the swing arm goes up and down.



Pic 2 brake-side

## 4 Attach the left-side foot peg plate to the motor bike body

(1) Attach the peg to the body.

(2) Attach the change ring boss and then attach the change pedal plate assy.

(3) Attach the change arm. Connect the change arm and change pedal plate by using STD change rod. (Pic. 3)

(4) Adjust the length of the change rod and position of the pedal.

Make sure the screws have more than 6mm engagement at the all three change rods.

(5) Check no parts interfere with others.

Check all bolts and nuts are securely tightened.



Pic 3 Change-side

## 5 Adjustment of change rod

Tighten the change rod and adjust the change pedal height. If the spherical bearing is too short or long, and you cannot make to your required heights, change the angle of the change arm and adjust the length of the change rod.

- For reverse change, use other side shift rod attachment position. ( Pic. 1)

## 6 Confirmation

(1) Check before run

- No parts interfere other parts. (Especially moving parts.)
- All moving parts work smoothly.
- All bolts and nuts are securely tightened.
- If the rear brake works.
- If the brake light operates.

(2) Check after the run

- If the shift to each gear can be done smoothly.
- If all bolts and nuts are still securely tightened.

## 【Maintenance】

Please keep the bearing and spherical bearing parts oiled at all times to ensure smooth operation. The bolts and nuts can be loosened by vibration. Please regularly tighten them. Especially after a fall, check the bolts and nuts.

【Parts list】 Utmost care is provided to the quality for the product. In case of ambiguity, stop using it immediately and contact us. Please contact below for inquiry on installation and maintenance, or claims.

No.	item name	qty.
1	STEP PLATE (LEFT)	1
2	STEP PLATE (RIGHT)	1
3	MASTER CYLINDER STAY	1
4	HEEL GUARD (L)	1
5	HEEL GUARD (R)	1
6	STEP BAR (R)	1
7	STEP BAR (L)	1
8	BRAKE PEDAL PLATE	1
9	CHANGE PEDAL PLATE	1
10	PEDAL END	2
11	FLUSH BOLT M6 X 25	2
12	PEDAL INNER COLLAR SUS1415	1
13	PEDAL END RUBBER	2
14	CAHNGE ARM	1
15	HEXAGON FLANGED BOLT M6X20	1
16	SPHERICAL BEARING JAM6	1
17	SWITCH STAY	1
18	CHANGE LINK BOSS	1
19	ALUMINUM COLLAR 12X6.2X8	1
20	ALUMINUM COLLAR 12X6.2X3	1
21	ALUMINUM COLLAR 13X8.2X2	1
22	SPHERICAL BEARING JAML6	1
23	BUTTON BOLT M6X10	5
24	BUTTON BOLT M6X15	2
25	BUTTON BOLT M6X20	3
26	BUTTON BOLT M6X25	1
27	BUTTON BOLT M6X30	1
28	BUTTON BOLT M8X35	1
29	BUTTON BOLT M8X40	1
30	THIN ROCK NUT M6R	1
31	CAP BOLT M8X25	4
32	FLANGE ROCK NUT M8X40	1
33	FLANGE ROCK NUT M8X45	1
34	FLUSH BOLT M8X35	1
35	WASHER M8X22X1.6	2
36	FLANGE ROCK NUT M8	1
37	ROCK NUT M6R	2
38	NUT M6	1
39	NUT M6L	1
40	THIN ROCK NUT M8R	1
41	BRAKE SWITCH SPRING HOOK	1

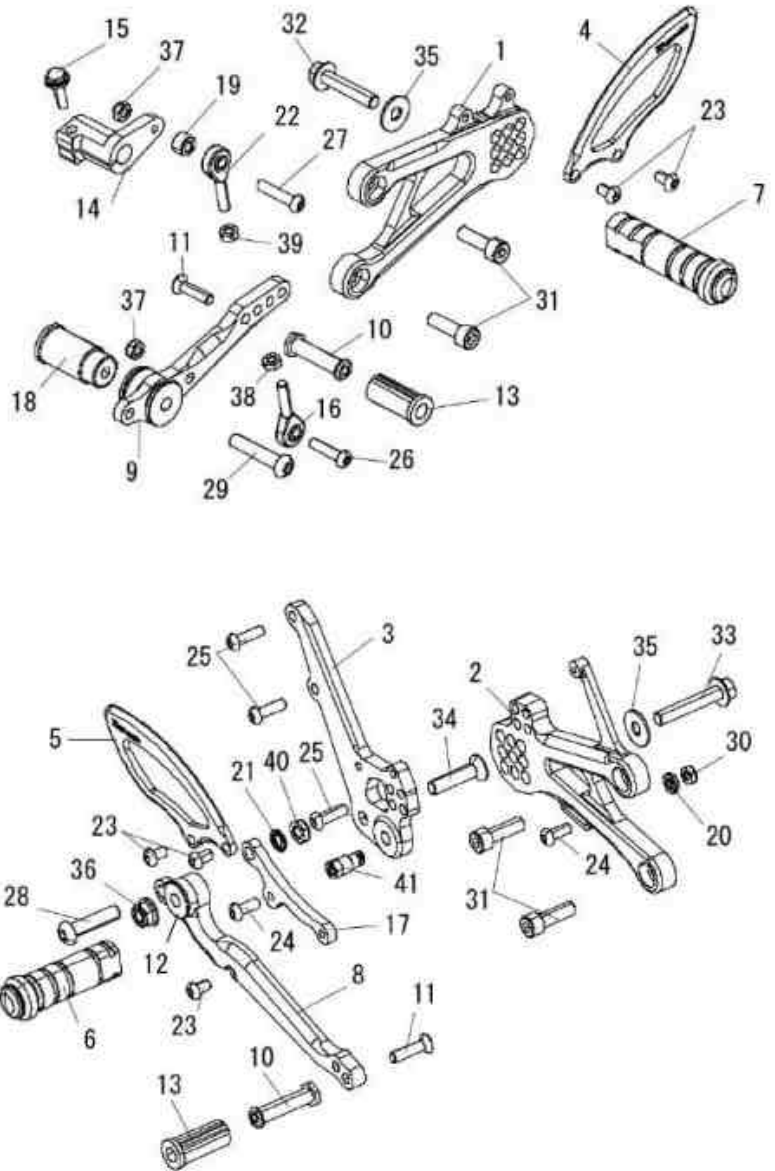

TiForce Japan Co., Ltd.  
 8160-1, Kohanba, Kou-cho,  
 Suzuka city, Mie  
 513-0836, Japan

81-593-701881 tel  
 81-593-701882 fax

<http://www.tiforce.co.jp/>  
[sales@tiforce.co.jp](mailto:sales@tiforce.co.jp)